

ISOFIX is a world-wide standardised interface between car and child seat. It minimises installation faults and optimises protection through a rigid connection between child seat and car. The ISOFIX-Standard has been in force since February 2004. More and more cars have standardised ISOFIX anchorage points or can be equipped with them optionally.

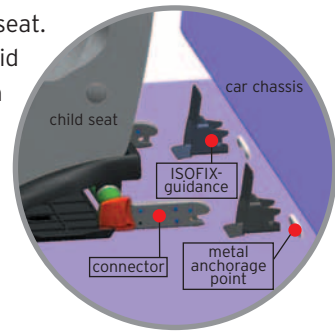

### Is your car equipped with ISOFIX anchorage points?

The child seat can be installed with ISOFIX, provided a **car-specific approval** is available. RÖMER DUO plus has been approved for a range of vehicles (list of approved cars!).

**Current list of approved cars under [www.britax-roemer.de](http://www.britax-roemer.de)**



### Does your car feature additional 'TopTether' anchorage points?

With an extra strap, the so-called TopTether, the connection between the ISOFIX installed child seat and the car seat is additionally stabilised. However, currently less than 10% of all Europe-wide approved cars are equipped with the anchorage point necessary for TopTether.

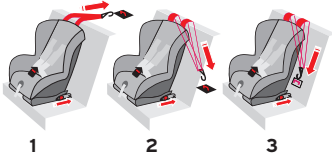

Upper anchorage point - fastening modes:

- 1 on the parcel shelf
- 2 on the floor
- 3 behind the backrest

The child seat (with TopTether included in the delivery or additionally available) can be installed in all cars which feature a TopTether anchorage point. RÖMER DUO plus has the **universal approval** required for this purpose.

### Advantages of ISOFIX at a glance:

- **standardised fastening for simple, quick installation and removal**
- **safe, firm connection between child seat and vehicle**
- **optimised protection in an accident**
- **even an unoccupied child seat is fixed in the car**
- **in a second car without ISOFIX anchorage points the child seat can be used universally with normal car seat belts**